

Installation Manual

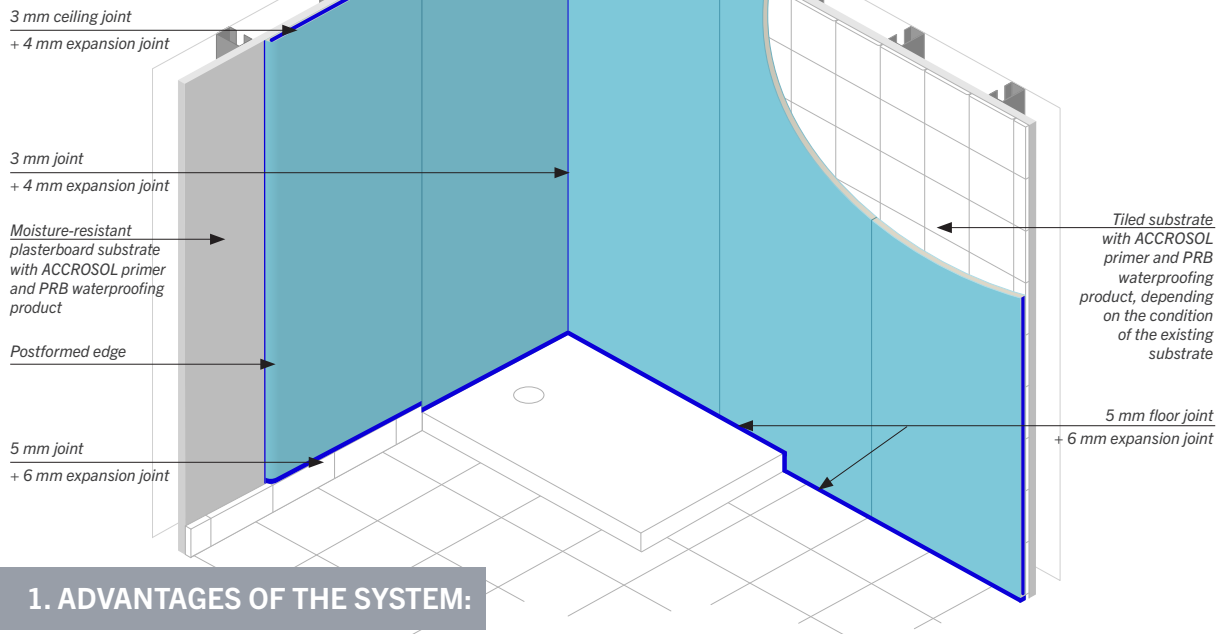

Wetwall™ nuance WATERPROOF PANEL SYSTEM for wall cladding in wet rooms



1. ADVANTAGES OF THE SYSTEM:

Perfect for new builds and renovations

Nuance is a **patented wall cladding solution** that is ideal for **new wetrooms** or **renovations**. It can be used **instead of or on top of tiles**, on moisture-resistant plasterboard and on any surface suitable for wet rooms.

Design

- Installing large full-sized panels
- The joints are almost invisible: vertical assembly is made easier thanks to our patented tongue-and-groove system and Complete sealant
- No trims or connecting profiles
- Panels with postformed edges can be used at the end of a section of panelling

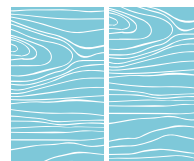

Assembling two Nuance panels

Every panel is different to ensure a natural, realistic finish. We cannot guarantee that the decor of one panel will blend seamlessly into the next. You can minimise this effect by opting for plain decors or small patterns.

Optimised panels

- Size tailored to construction standards
- Optimised panel widths from 600 to 1200 mm
- 11.7 mm thickness ensures toughness and rigidity
- Panels can be adapted to the configuration of any wet room
- Bath and shower areas can be fitted separately or together

Time-saving

- Can be installed directly on site or assembled remotely with minimal downtime and a shower that is ready for use just 24 hours after installation.
- Clean installation: dry assembly
- Dust-free application
- Vertical gaps and cut outs can be immediately back-filled after bonding the panels in place
- Easy to cut on site with standard woodworking tools
- Immediate adhesion means that the wall panelling can be completed in one go
- 3 types of panels available to suit all layouts
- Lightweight material
- Quick-fit Safe&Connect assembly system.

Hygienic

- Large, flat, stud-free, water-resistant surface that significantly reduces mould and mildew growth
- Antibacterial surface treatment
- Sanitary grade Complete sealant that meets SNJF requirements - antibacterial and antifungal, solvent-free and silicone-free

Easy to maintain

- Easy to clean with a sponge and everyday spray cleaning and descaling products
- Compatible with standard and professional disinfectants (see Care & Maintenance manual)
- Can be rinsed with water and dried with a squeegee
- Wipe with a microfibre cloth so that no marks form from residue left behind

2. APPLICATIONS

- **Wall panelling around showers and baths in wet rooms**
- **Wall panelling in dry areas of bathrooms**
- **Bath panelling**
- **Half-height or full-height toilet wall panelling**
- **Splashbacks for sinks & washbasins** (these can be installed using standard panelling techniques)

3. OUR PRODUCT SOLUTIONS

	WATER-REPELLENT WALL PANELS			Adhesive	Sealant
	NUANCE			COMPLETE	COMPLETE
THICKNESS	11.7 mm			-	-
SIZES/QUANTITIES	260 x 120 cm	260 x 60 cm		290 ml	290 ml
TYPE	Postformed edge & tongue	Tongue & groove	Tongue & groove	Moisture-resistant Excellent adhesion Adhesive cure time < 30 min Bond strength ≥ 1 N/mm ² Solvent-free and odourless Provides immediate panel adhesion Approved for use with the Nuance system Shelf life: 12 months from date of production	Sanitary grade Waterproof to running water at pressures of <6 bars Moisture-resistant Excellent durability Sealant cure time: 55 min Solvent-free and odourless Antibacterial and antifungal Shelf life: 18 months from date of production
WEIGHT	28 kg	28 kg	14 kg	-	-
FIRE RATING	M3			-	-
COMPOSITION	High pressure laminate (HPL) + water-repellent composite substrate + adhesive with excellent resistance to water and high temperatures			MS polymer (high adhesion)	MS polymer (high adhesion no yellowing)
FINISHES	Please refer to the Nuance selection			-	-
DECORS	Please refer to the Nuance selection			White	Colours to match the different decors in the range Please refer to the brochure.

4. BASIC PRINCIPLES

This guide summarises the main principles involved in installing the product. For more information, please contact us.

Warehouse storage

Panels: Store horizontally in the original packaging, indoors, in a dry, temperate room where the humidity does not exceed 60%. Strapping may damage the panels.

Adhesive: A maximum of 12 months from the date of production.

- In a closed storage area under normal indoor climatic conditions (10 to 20°C and 40 to 60% relative humidity).
- In its original packaging.

Sealant: A maximum of 18 months from the date of production.

- the Complete sealant must be stored in a closed storage area under normal indoor climatic conditions (10 to 20°C and 40 to 60% relative humidity).
- In its original packaging.

Where to find the production date of our Complete adhesives and Sealants

You will find a four digit code on the cartridges, the first digit corresponds to the year of production and the third digit corresponds to the week of production. Using these two digits, you can identify the month in which your cartridge was produced.

On-site storage and packaging

- Panels should be stored horizontally in their original packaging at a temperature and humidity level close to normal use conditions (18-20°C and 40-60% RH)
- Adhesives and sealants should be stored at a recommended temperature of 18-20°C
- At least 24 hours before use, unpack the products and place them in the area where they are to be installed
- Open the packaging by hand without using sharp tools (the decorative side of the panel should face towards the opening of the packaging)
- Once unpacked, store horizontally, decor side up, for a maximum of 24 hours

Our expert advice

When using adhesives and sealants, ensure that the temperature is at least 15°C in winter and summer, and do not store them in direct sunlight or in a place where the temperature exceeds 25°C, in order to preserve all their properties and make them easier to apply.

Enjoy peace of mind with our 15-year guarantee

Our 15-year guarantee is a product guarantee. It only covers manufacturing defects in the Nuance panels. Its validity is subject to compliance with the installation recommendations, including the use of the Complete adhesive and sealant, and strict compliance with the maintenance and care recommendations (documents available on polyrey.com).

The Complete adhesive and sealant have been specially developed and tested for use with Nuance panels.

The Complete adhesive and sealant must be used to validate the 15-year guarantee.

5. TOOLS & MATERIALS

These steps will show you how to set the installation up, cut the panels to size and install them.



Nuance panels (number and type to be defined according to the project), Complete adhesive (2.5 cartridges for a 260 x 120 cm panel) and Complete sealant in the same colour as the decor of the panel (1 cartridge for 10 linear metres)

Suction cup lifter (glass puller type)

A circular saw with a guide rail and a carbide-tipped blade with at least 44 trapezoidal teeth to cut the panels to the required dimensions

A jigsaw with a small-toothed, carbide-tipped metal cutting blade for shaping the panels

A drill with a drill bit with a minimum diameter of 6 mm and a 35-40 mm diameter hole cutter (or hole saw)

A manual or battery-operated caulking gun to apply the Complete adhesive and sealant

A screwdriver, tape measure, cutter (to make the 7 x 7 mm V-shaped cut-out in the cartridge nozzle for applying the beads of adhesive), a pencil and masking tape

PRB substrate preparation products: ACCROSOL, SPEC PRESERFOND, waterproofing strips for floor/wall joints and wall corners, and waterproof reinforcements around water inlets

A straight edge and a spirit level

Wedges of various thicknesses to create the necessary gaps (glazing packers of at least 5 and 3 mm)

Personal protective equipment: mask, goggles, gloves and ear plugs

4 and 6 mm expansion joints (EPDM foam)

Associated PRB products for substrate preparation: fixative primer (Accrosol AG or Accrosol Express), under-tile waterproofing resin (Preserfond or Monocel), corner reinforcement strips and water inlet waterproof reinforcements and adhesive mortar for filling and levelling (COL FLEX, MONOFLEX HP, COL SPID HP & COL TOP)

Applicator roller

Microfibre cloth

Silicone scraper for joints

White spirit or stain remover

Soapy water spray

Masking tape

Plastic wall plugs, minimum length 40 mm

6. SYSTEM INSTALLATION

in accordance with ATEX CSTB N° 2977

1. PREPARE THE SUBSTRATE

Check the substrate

Check the condition of the substrate (new or old):

- Flatness
- Squareness
- Porosity
- Fill any holes with adhesive mortar (PRB)
- Remove any damaged tiles if installed on a tiled surface

Prepare the substrate

Prepare the substrate to be covered with the Nuance panel in accordance with the French DTU 52.2 (Bonded installation of ceramic and similar coverings):

- Apply a fixative primer
- Apply an under-tile waterproofing system (SPEC)

Our expert advice

For thickness adjustments, use the PRB adhesive mortar for levelling

Use PRB Accrosol fixative primer and PRB Preserfond or Monocel under-tile waterproofing system (SPEC)

2. MEASURING THE DIMENSIONS

- Start by clearly defining the area to be covered with the Nuance system.
- Decide on the layout of the panels, taking into account any expansion joints (empty space to be left in corners).

Height:

- Measure the height from the shower tray to the ceiling (or from the top of the bath to the ceiling)
- Subtract 3 mm for the joint between the panel and ceiling and 5 mm for the joint between the panel and the shower tray

Width:

- Measure the length/width of the shower tray (or bathtub)
- For the internal angle between panel A and the wall:
 - allow for an expansion joint of at least 5 mm, depending on the length of the panelling to be installed
 - between panel B and panel A: 3 mm waterproof seal using the Complete sealant and a 4 mm expansion joint

Water inlets:

- Measure and mark the position of the water inlets on the panel (marks a, b, c and d)

Our expert advice

When taking measurements, bear in mind that the panel always sits on top of the shower tray, bath or finished floor.

When applying between two walls, remember to respect the recommended additional expansion joint:

For "standard" installations, the corner expansion joint must be 5 mm: between walls no longer than 2.40 m.

For other installations, the expansion joint must be 7 mm: between walls no longer than 3 m.

If the length to be panelled is in a wet room and is longer than 3 m, allow a 4 mm expansion joint between the panels.

2. MEASURING THE DIMENSIONS

Diagram 1: Determining the location of water inlets and minimum distances from joints and cuts

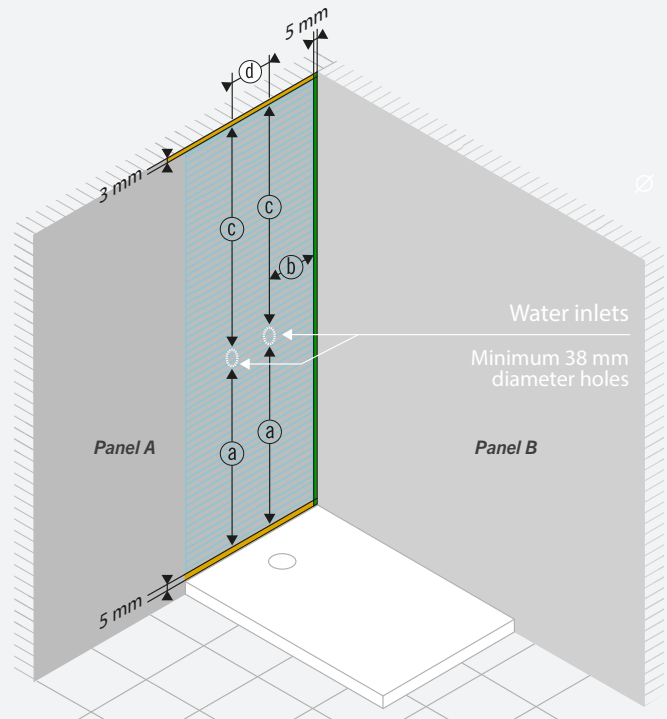

3. PROCESSING

- Place the panel on a stable surface (decor side down)
- Mark out the cutting lines
- Position the guide rail
- Cut with a circular saw (fitted with carbide-tipped blade)
- You can use a cutter to cut off the tongue

Our expert advice

To achieve a clean and neat cut, we recommend the use of tools specifically designed for working with HPL, together with carbide-tipped blades and drill bits.



Diagram 2: Cutting off the male part (tongue)

4. DRILLING

- Place the panel on a stable surface (decor side up)
- Mark the water inlets on the decorative side of the panel
- Use an all-materials hole cutter (or hole saw) with carbide or diamond teeth of the appropriate diameter
- Drill out the holes

Our expert advice

When drilling (using a hole saw or a hole cutter suitable for cutting composite materials), make sure that the decorative side is facing upwards. For water inlets, we recommend using a 38 or 40 mm diameter hole saw.

5. DRY-FITTING THE PANEL

- Position the panel using the corresponding wedges
- Leave a gap for:
 - The 3 mm joint between the panel and ceiling
 - The 5 mm corner expansion joint between panel A and the wall ("standard" installation)
- Leave 5 mm for the joint between the panel and the shower tray
- Check that the panels are plumb, level, square and flat. If you are having difficulty fitting the panels together, make sure they are plumb and level.

- For "standard" installations: 5 mm expansion joint: between walls no longer than 2.40 m (diagram A)
- For other installations: 7 mm expansion joint: between walls no longer than 3 m (diagram B)
If the length to be panelled is in a wet room and is longer than 3 m, allow a 4 mm expansion joint between the panels

Diagram 3: internal corner expansion joint

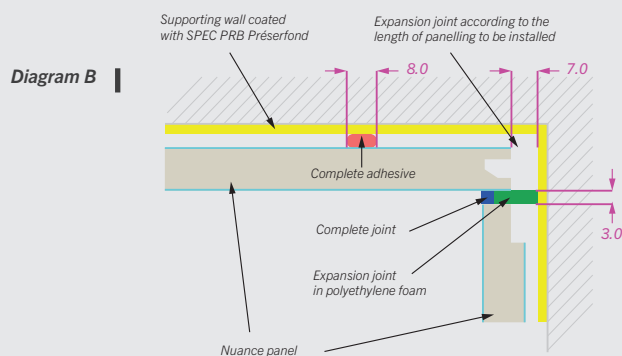
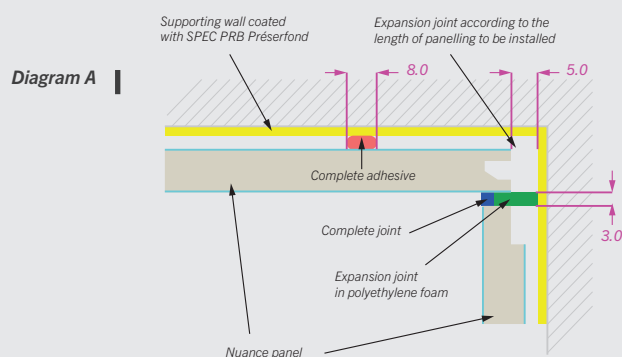

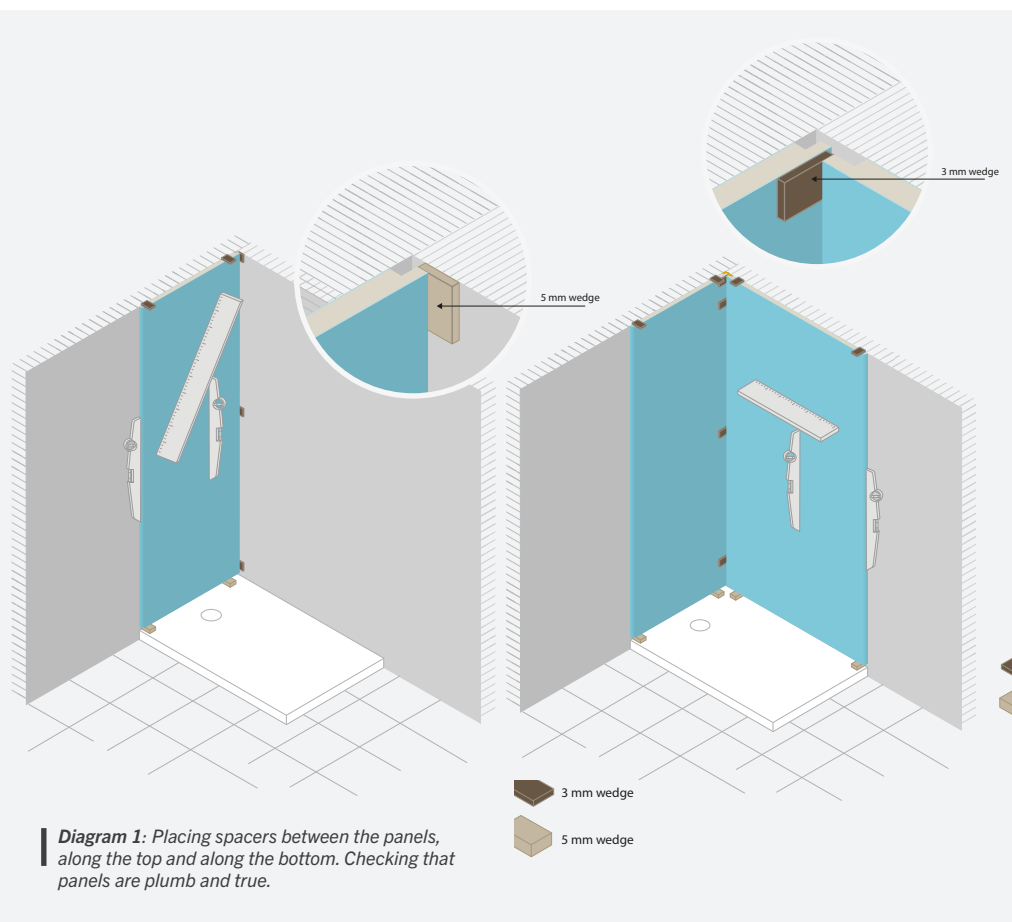

- Place the panel on a stable surface (decor side down)
- Clean the back of the panel with a damp cloth and leave to dry
- Cut the nozzle of the adhesive cartridge to the diameter of the bead (minimum width: 7 mm).
- Apply Complete adhesive to the back of the panel according to the plan

The bead of adhesive must be 7 mm wide by 7 mm high, the V-shaped cut-out in the cartridge nozzle ensures maximum precision.

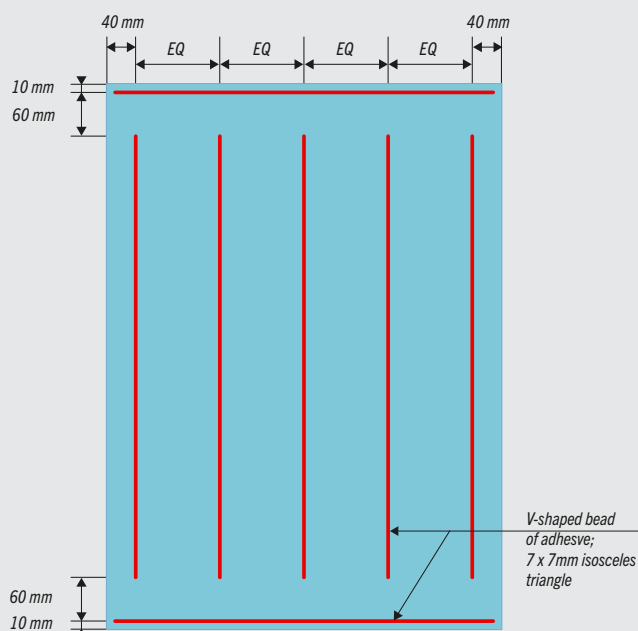

6. APPLY THE SEALANT AND ADHESIVE

Our expert advice

Consumption: 2.5 x 290 ml adhesive cartridges for a 260 x 120 cm panel.

Use a battery-powered caulking gun for easier application.

7. INSTALLING THE PANELS

- When applying the panels, always make sure to start in a corner. Take the thicknesses of the top, bottom and corner joints into account.
- Position the wedges at the bottom.
- Hold the panel in place with suction cup lifters
- Position the wedges in the corners on the wall side for the expansion joints
- Fit the panel
- Finish bonding by pressing firmly (without tapping) with a straight edge over the entire surface of the panel.
- When joining 2 panels, once the first has been installed, position the second at an angle of 5 to 10° to the wall.
- Before installing the second panel, apply a light bead of sealant (1 to 2 mm) to the tongue and groove of each panel.
- Finally, press the panels together until the sealant is evenly distributed over the entire length of the joint and wipe off any excess sealant (with a cloth soaked in White Spirit)

Our expert advice

Leave the expansion joint wedge between the panel and the wall: this wedges the panel while the adhesive sets and prevents the first panel from moving when the panels are pressed together.

Diagram showing how to assemble the panels and where to position the adhesive beads and COMPLETE sealant

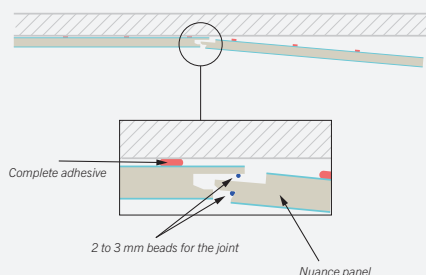
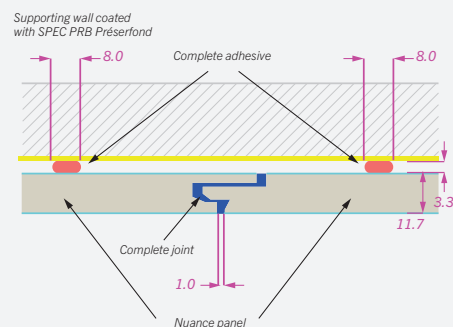

Diagram showing how the panels are joined



8. INSTALLING THE EXPANSION JOINT

- Fit the expansion joint:
 - 6 mm for the joint between the floor and the NUANCE panels
 - 4 mm for wall corners and for the joint between the ceiling and the NUANCE panels

This ensures optimum use of the Complete sealant (quantity + performance)

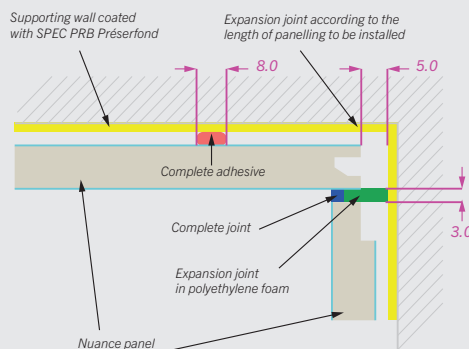

9. CAULK THE JOINTS

- Fill the joints evenly with the Complete coloured sealant
- The joint between panels must be tightly sealed using suction cups, positioned on the front of each panel. Tighten using a mechanical clamp to extrude any excess sealant between panels: remove the excess sealant with silicone or rubber scrapers.
- Clean with a microfibre cloth soaked in white spirit or stain remover

Our expert advice

Apply masking tape before applying the sealant and, once applied, spray the sealant with soapy water before smoothing. One 290 ml cartridge provides a 10 linear metre joint.

10. ATTACHING THE WALL FASTENERS

- Fix directly to the supporting wall. Never attach to the NUANCE panel
 - Pre-drill the panel with an 8 mm diameter HSS drill bit for a 6 mm diameter plastic wall plug to allow the panel to expand crosswise, then use a drill bit suitable for drilling into the supporting wall (tile, brick, plasterboard, etc.).
- Remember to allow for the expansion of the panel, i.e. 2 to 3 mm more than the diameter of the wall plug.
- Seal the perimeter of the holes and fixings with the expansion joint and sealant, taking care not to overtighten so as to jam the panel against the wall with the fitting accessories.

Our expert advice

Use plastic wall plugs for solid or hollow materials of a length that takes into account the final thickness of the 15 mm Nuance system. When renovating over tiles, remember to add the thickness of the tiles.

Fixing the shower screen through the Nuance panel

- The shower screen can be fixed at the joint between the panels.
- Apply Complete sealant around drill holes and attachments

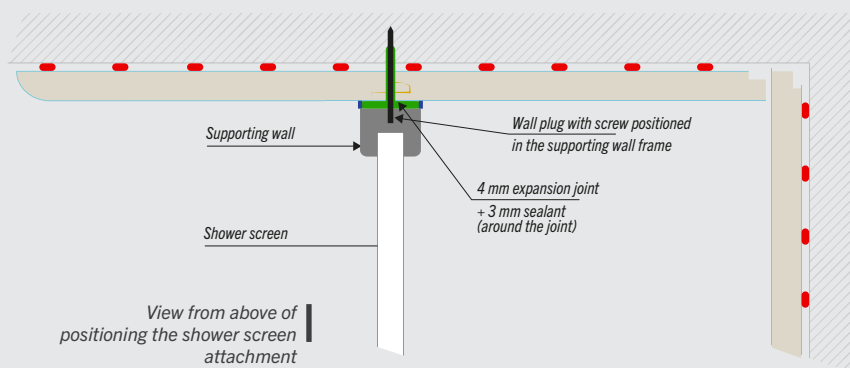

Fixing the shower screen directly to the supporting wall

- Fill the vertical joints along the shower panel using 3 mm of Complete coloured sealant

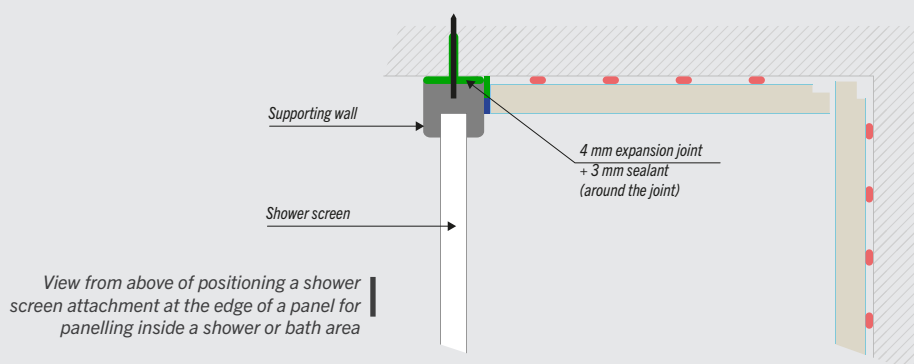

SPECIFIC POINT: FLOOR CONNECTIONS

FILLING THE GAPS AROUND SHOWER TRAYS AND CEILINGS

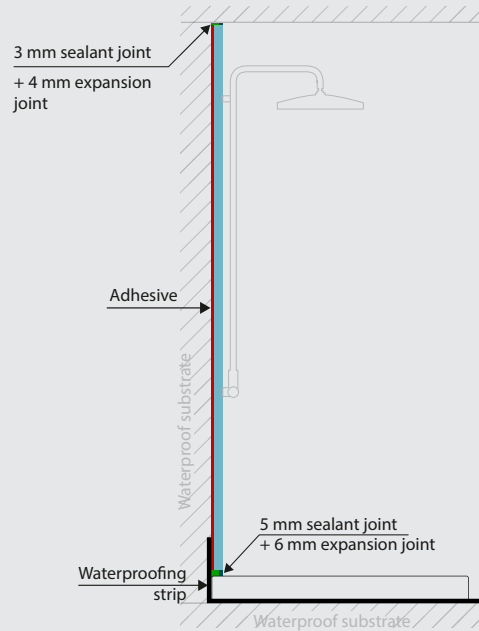

FILLING THE GAPS AROUND FLOOR TILES AND CEILINGS

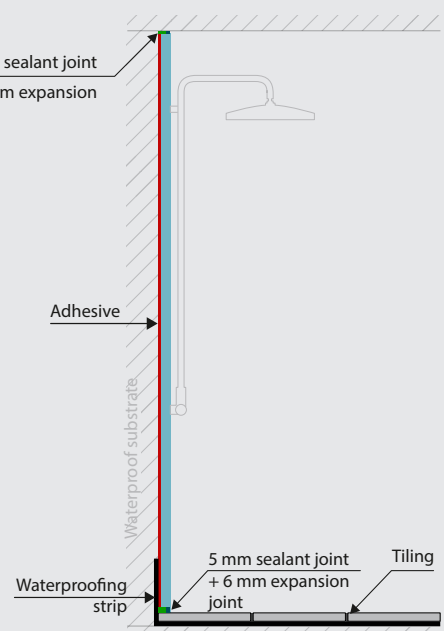

FOR FILLING THE GAPS AROUND FLEXIBLE PVC FLOORING WITH SKIRTING

Contact POLYREY
by phone on +33 (0)5 53 73 56 89

SPECIFIC POINT: PANELLING EXTERNAL ANGLES WITH POSTFORMED EDGING

- Make sure there is a 2 mm vertical bead of sealant where the 2 panels meet
- Install the first panel
- When installing the second panel, remember to allow for the thickness of the adhesive remaining from the last panel installed

Our expert advice

Make sure the corner is plumb and level
Tape the two panels together tightly while the adhesive sets

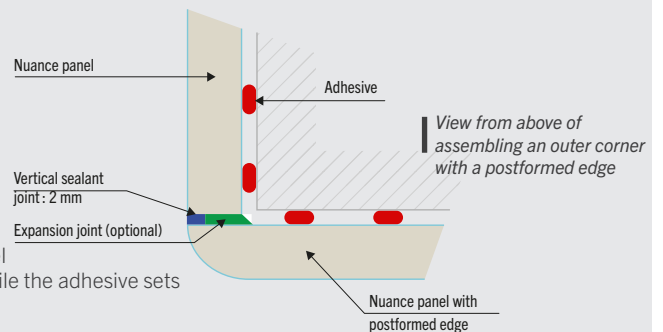

SPECIFIC POINT: CUTTING AROUND A SHOWER TRAY

- As with High Pressure Laminate (HPL), internal right-angle cuts should be avoided
- Drill at the right angle using an HSS drill bit (Ø 5 mm)
- Finish the cut with a jigsaw (fitted with a metal cutting blade)
- Leave a 5 mm gap for the sealant and expansion joint

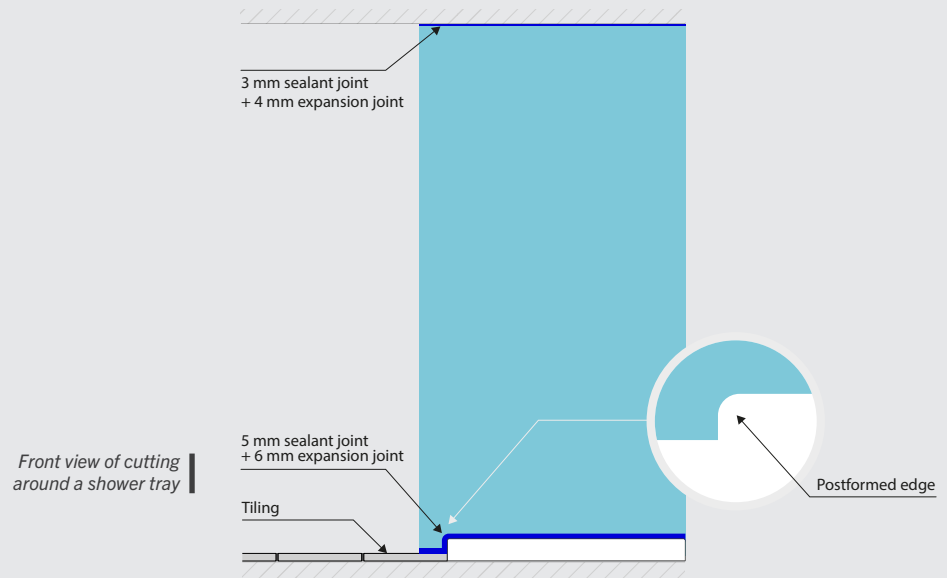

Our expert advice

Always drill on the decorative (front) side

- Design the layout of the panelling
- Determine the dimensions of the panel to be fitted over the cut-out to install a solid panel with a postformed edge
- Cut the tongue off the postformed panel or off the first panel of the run
- Use the wedges to check the position of the panels before applying the adhesive
- Remember the sealant joints at the top and bottom
- Apply adhesive to the panels and press them into place

SPECIFIC POINT: THE END OF A SECTION OF PANELLING ON A SUPPORTING WALL

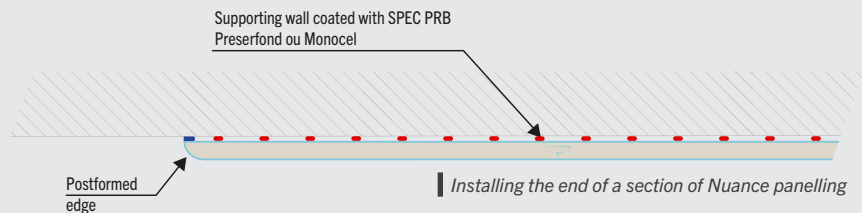

Our expert advice

For shower trays larger than 120 cm, use 260 x 120 cm panels with grooves

7. SPECIAL CASES

SPECIFIC POINT: REMOVABLE BATH PANELLING

- **OPTION 1:** As with tiling, build a substrate (using plasterboard, gypsum blocks, Siporex, etc.) and then bond the Nuance panels in place.
Add an access panel.
This system cannot be dismantled, but the pipework and plumbing can be accessed through the access panel.
- **OPTION 2:** build a vertical and horizontal wooden frame using at least class 3 wood: beech, oak, etc.
 - Position and secure using suitable accessories screwed to the frame at regular intervals at the top and bottom of the horizontal parts of the frame and on the vertical parts of the frame.
 - If you would like to use removable fixing systems such as clips, please contact POLYREY on +33 (0)5 53 73 56 89 or by e-mail: support.technique@polyrey.com

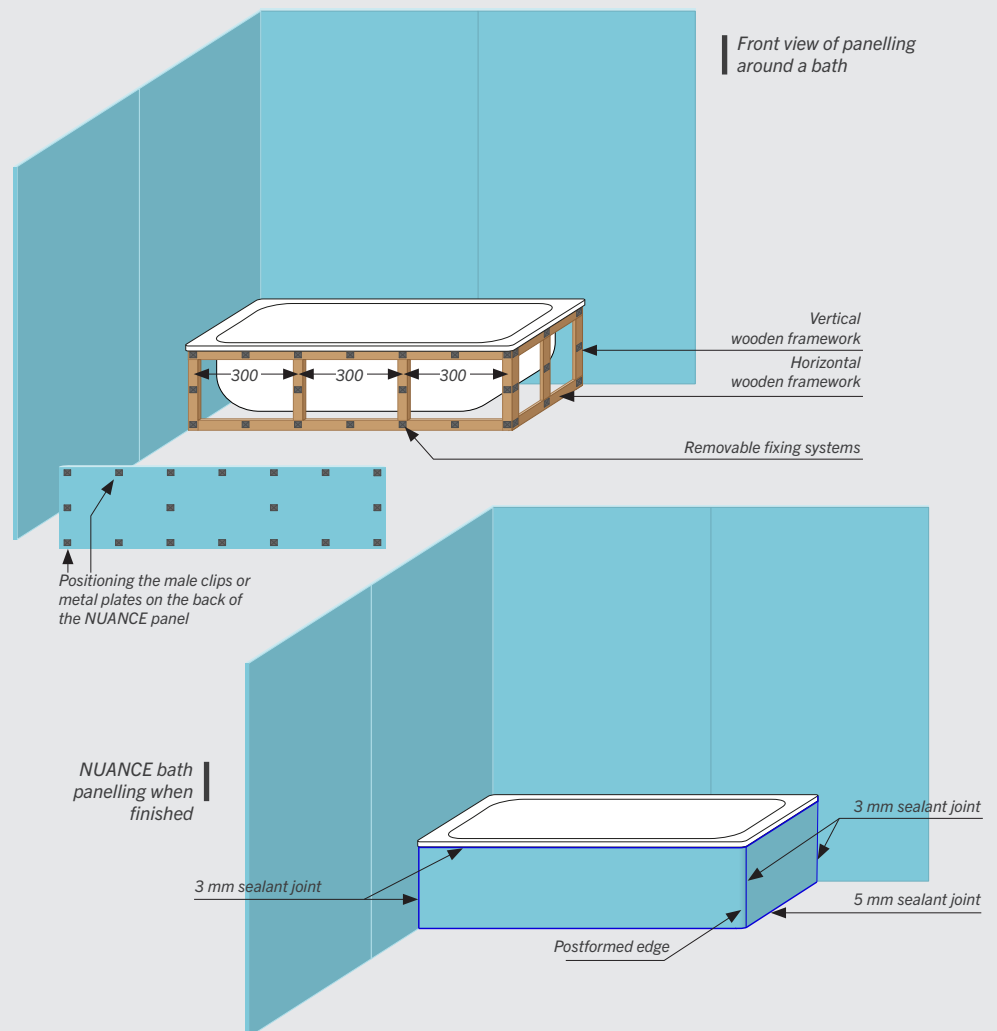

Our expert advice

For wooden frames, the distance between battens should not exceed 300 mm. Reducing the distance between the frame axes to 300 mm improves mechanical strength and shock resistance. Nuance panels must always be glued with beads of adhesive, not dots.

SPECIFIC POINT: TOILET SURROUNDS AND WASHBASIN SPLASHBACKS

- Use a panel with a postformed edge for external corners.
- Turn the panel at 90° to create an upstand for a washbasin splashback or wall (max 1200 mm high) with the postformed edge.
- Since the edges are rough, this sort of configuration is only possible by using aluminium or PVC tile spacers suitable for the thickness of the product. Minimum recommended shade: 12.5 mm.
- Follow the general instructions above